ATTACHMENTS DISTRIBUTED UNDER SEPARATE COVER

**CCL 22/03/22 – TAURANGA ROAD, NEW LAMBTON – HALF ROAD
CLOSURE AT LAMBTON ROAD**

PAGE 3	ITEM-27	Attachment A:	CCL220322 - Tauranga Road at Lambton Road – Half Road Closure
PAGE 6	ITEM-27	Attachment B:	CCL220322 - Tauranga Road at Lambton Road - Consultation Flyer
PAGE 10	ITEM-27	Attachment C:	CCL220322 - Tauranga Road, New Lambton - Summary of Submissions

ATTACHMENTS DISTRIBUTED UNDER SEPARATE COVER

**CCL 22/03/22 – TAURANGA ROAD, NEW LAMBTON – HALF ROAD
CLOSURE AT LAMBTON ROAD**

PAGE 3 ITEM-27 Attachment A: CCL220322 - Tauranga Road at
Lambton Road – Half Road Closure

DISTRIBUTED UNDER SEPARATE COVER

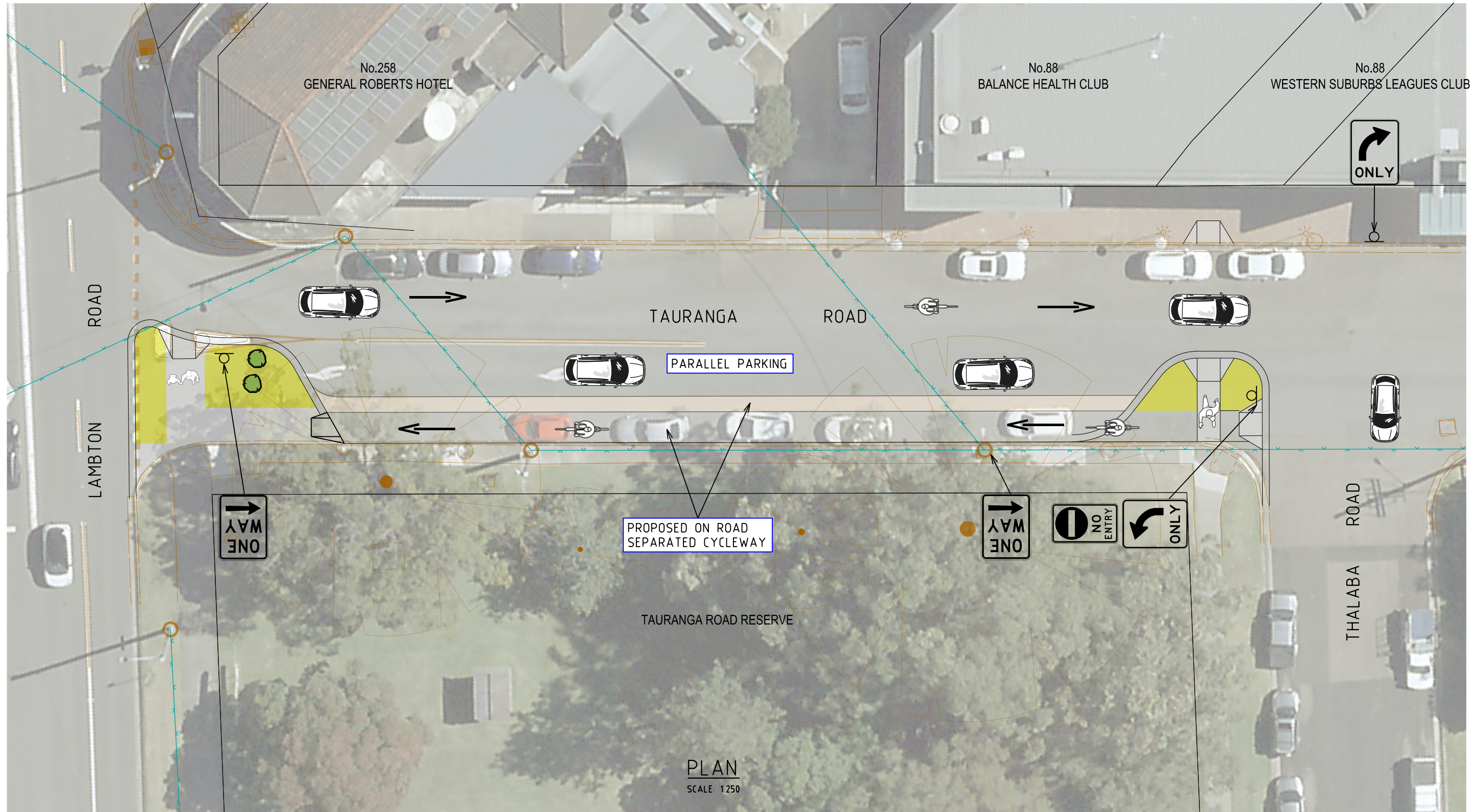

PLAN
SCALE: 1:250

LEGEND:	
	PROPOSED ON ROAD CYCLEWAY
	TURF/LANDSCAPING
	MEDIAN/SEPARATION
	CONCRETE RAMP

PDF created on: 10/27/08 AM

No.	AMENDMENT DETAILS	DATE	INITIALS
A	ISSUED FOR CONSULTATION	05-11-21	BD
A3 ORIGINAL THIS SHEET WAS PREPARED IN COLOUR AND WILL BE INCOMPLETE IF COPIED			

SCALE	AS SHOWN
COORDINATE SYSTEM:	MGA ZONE 56
HEIGHT DATUM:	AHD

	INFRASTRUCTURE AND PROPERTY ASSETS AND PROJECTS CIVIL SERVICES TEAM
DESIGNED:	A DESIGNER
REVIEWED:	A REVIEWER

MICROSTATION FILE:	PRJ-00201296_01.dgn	SUR:	A SURVEYOR
12d PROJECT FILE:	C4459_DESIGN.project	F.B.:	540
PPM PROJECT No.:	PRJ 00201296	L.B.:	-
CONSULTATION			

CITY OF NEWCASTLE	
TAURANGA ROAD NEW LAMBTON BETWEEN LAMBTON ROAD AND THALABA ROAD HALF ROAD CLOSURE	

CN PLAN No.	R7929	SHEET No.	1
AMENDMENT No.	A	OF	1
		SHEETS	

ATTACHMENTS DISTRIBUTED UNDER SEPARATE COVER

**CCL 22/03/22 – TAURANGA ROAD, NEW LAMBTON – HALF ROAD
CLOSURE AT LAMBTON ROAD**

PAGE 6

ITEM-27

Attachment B:

CCL220322 - Tauranga Road at
Lambton Road - Consultation Flyer

DISTRIBUTED UNDER SEPARATE COVER



Background

The signalised intersection of Alma Road and Lambton Road is in close proximity to Royal Place and Tauranga Road. Traffic from Lambton Road (northwest of Tauranga Road) can turn left on the green signal and continue on Lambton Road towards Broadmeadow, or turn left and then position for a right turn into Royal Place. Should a vehicle from Tauranga Road attempt the same movement, there is high potential for an accident.

Signage has been installed in Tauranga Road to discourage these movements (left from Tauranga Road into Lambton Road and right into Royal Place) however the signage is often ignored, and other measures implemented to prevent the movement have had limited effect.

We have been offered funding under the Australian Government Black Spot Program to address the intersection.

How we use feedback

We are seeking community feedback to make an informed decision on this project.

To view the concept design and provide feedback, visit newcastle.nsw.gov.au/yourSay and complete the online form.

Alternatively, you can email a written submission to mail@ncc.nsw.gov.au. Please include 'Submission – Half Road Closure – Tauranga Road at Lambton Road, New Lambton' in the subject line.

Postal submissions can be sent to:

Chief Executive Officer

City of Newcastle

Attention: Transport and Compliance

PO Box 489

Newcastle NSW 2300

Subject: Submission – Half Road Closure
– Tauranga Road, New Lambton

Proposed Half Road Closure – Tauranga Road at Lambton Road, New Lambton



*Changes are proposed on Tauranga Road
at Lambton Road.*

The public exhibition period will close
at 5pm on Monday 17 January 2022.

We are seeking feedback on a proposal for traffic changes on Tauranga Road, New Lambton between Thalaba Road and Lambton Road.

What is proposed

The proposed changes involve a half road closure and one-way traffic northbound on Tauranga Road, between Lambton Road and Thalaba Road.

Works include:

- Construction of kerb extensions on the side of Tauranga Road at Lambton Road and at Thalaba Road, with footpath connections and kerb ramps
- Construction of a kerb ramp on the western side of Tauranga Road
- Landscaping of kerb extensions
- New signage and linemarking to indicate one-way traffic flow northbound on Tauranga Road between Lambton Road and Thalaba Road

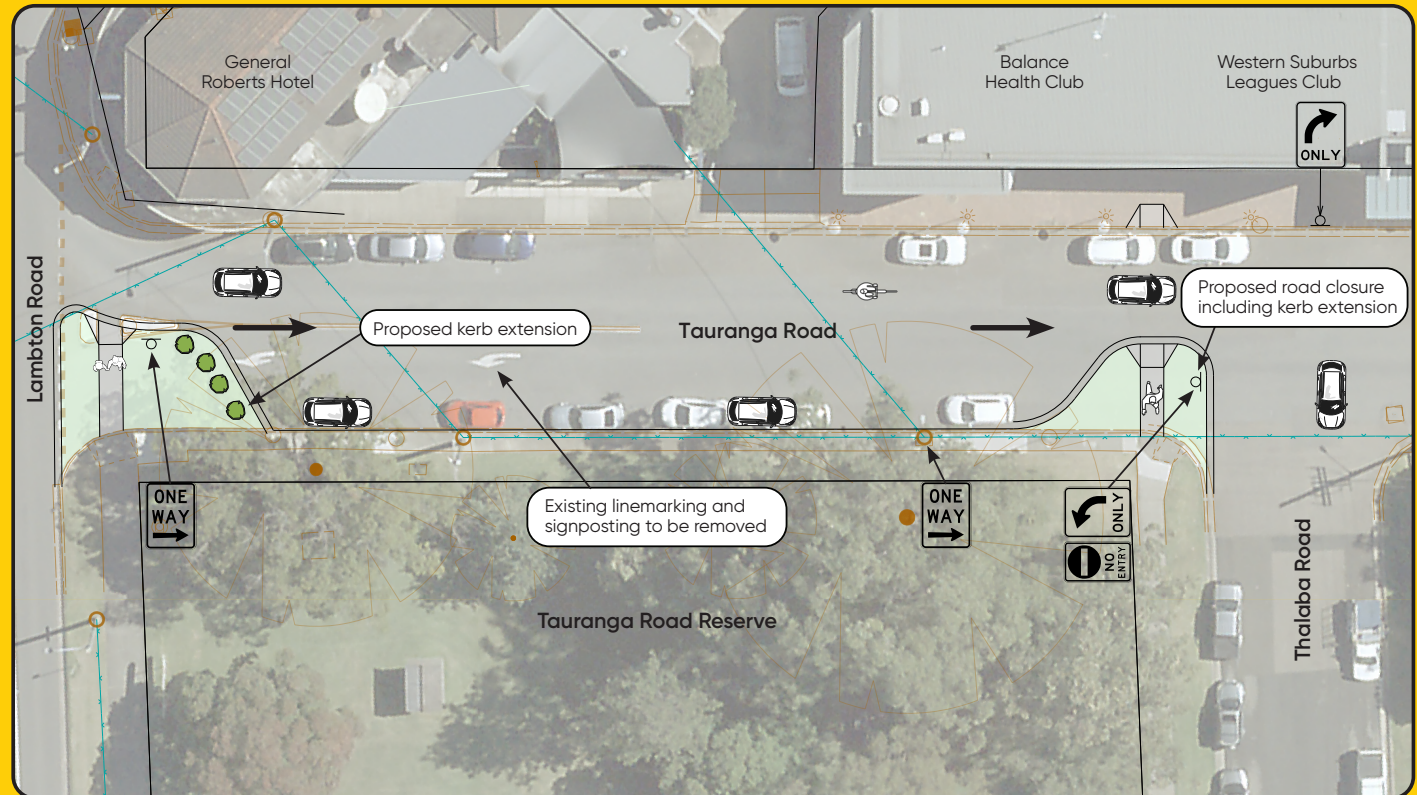

The half road closure will improve safety at the intersection of Tauranga and Lambton Road.

ATTACHMENTS DISTRIBUTED UNDER SEPARATE COVER

**CCL 22/03/22 – TAURANGA ROAD, NEW LAMBTON – HALF ROAD
CLOSURE AT LAMBTON ROAD**

PAGE 10 ITEM-27 Attachment C: CCL220322 - Tauranga Road, New
Lambton - Summary of Submissions

DISTRIBUTED UNDER SEPARATE COVER

SUMMARY OF SUBMISSIONS – HALF ROAD CLOSURE AND ONE WAY TRAFFIC NORTHBOUND – TAURANGA ROAD, NEW LAMBTON

No.	Document Date	Reference	Suburb	Support	Summary of Submission	CN Response
1	24/12/2021	TR2022/00010	New Lambton	Yes	Respondent supports the proposal, considering the measures inevitable necessary to prevent manoeuvres that are still being undertaken by many drivers (in contradiction to the signage).	Noted.
2	3/01/2022		New Lambton	Yes	Respondent supports the proposal, noting that as long as parking is maintained it would be an effective solution to an ongoing problem.	Noted.
3	10/01/2022	TR2022/00040	New Lambton Heights		Respondent suggested implementation of lane delineation or other line marking to guide traffic away from the kerb, in the vicinity of 242 Lambton Road. Respondent suggested that right turn from Royal Place to Lambton Road east be banned. Respondent noted that vehicles in storage lanes on Lambton Road (for vehicles turning right and continuing north on Lambton Road through traffic signals) may impede sightlines of westbound traffic to vehicles on Lambton Road wanting to turn right into Royal Place (and vice versa). Respondent noted concerns with the intersections of Lambton Road with Wallarah Road and Greta Road.	Delineation is supported. Banning of right turn from Royal Place to Lambton Road east is supported. The intersections noted have a long history of issues. Traffic modelling by Transport for NSW is in progress. Further investigation and liaison between Transport for NSW and City of Newcastle is required to determine potential improvements.
4	10/01/2022		New Lambton	Yes	Respondent supports the proposal but notes there will likely be an increase in traffic on Thalaba Road and that it will funnel traffic to another problem area, the intersection of Lambton Road and Wallarah Road.	Noted. CN is pursuing discussions with Transport for NSW regarding the potential for traffic control signals at the intersection of Wallarah Road and Lambton Road.
5	11/01/2022	TR2022/00080	New Lambton	Yes	Respondent strongly supports the proposal, and considers it long overdue. Respondent notes that previous measures to control the left turn, right turn out of Tauranga Road into	Noted. Banning of the right turn from Royal Place into Lambton Road is supported.

No.	Document Date	Reference	Suburb	Support	Summary of Submission	CN Response
					<p>Royal Place have not been successful. Respondent notes that traffic turning left turn from Tauranga Road (and continuing east) must negotiate the turn at low speed. Several rear-end collisions have occurred due to traffic at speed on Alma Road colliding with slow moving vehicles exiting Tauranga Road. Damage has been caused by heavy vehicles turning left and running over the kerb. Respondent makes the following suggestions: prohibit the right turn from Royal Place into Lambton Road heading east; prohibit the U-turn by traffic heading west along Lambton Road at the end of the traffic island adjacent to the Royal Place/Lambton Road intersection. Integrated signalisation of the entire Alma Road/Lambton Road/Royal Place intersection would be desirable.</p>	
6	17/01/2022		New Lambton	Yes	<p>Respondent supports the proposal. Respondent notes there is a high incidence of speeding on Lambton Road (between the roundabout at Rugby Road and Avondale Road).</p>	<p>Noted. CN will refer the speeding issue to NSW Police.</p>
7	25/01/2022	TR2022/00143	New Lambton	Yes	<p>Respondent supports the proposal. Respondent requests that missing kerb ramps in the area be included in the project scope.</p>	<p>The project is subject to grant funding and its scope is essentially limited to that noted in the grant application. Missing/non-compliant kerb ramps throughout the city have been mapped and are addressed under City of Newcastle's Pedestrian Access and Mobility Plan Program, as resourcing permits.</p>